

SEAGATE

GAS RANGES

SGR-4-24, SGR-6-36, SGR-10-60,
SGR-6B-24MG-60

Every SEAGATE range is built to provide outstanding performance and is easy to install so that you can get to cooking faster.

Featuring a highly polished stainless steel exterior with a porcelain oven deck and oven door liner, this range is easy-to-clean and built to last. SEAGATE ranges include powerful heavy duty cast iron burners, each with a capacity of 30,000 BTU's, and 32,000 BTU's per oven.

SEAGATE ranges were designed to deliver quality at an affordable price.

SEAGATE, it means a great deal.



STANDARD FEATURES

- Ready for natural gas installation straight from the factory, comes with LP conversion kit
- Easy-to-clean, removable, heavy duty 12" x 12" cast iron top grates
- All non-ferrous stainless steel exterior, front, sides, landing ledge, valve controls, and kick plate
- Porcelain door lining and inner bottom deck for ease of cleaning and maintenance
- Adjustable temperatures from 250°F (121°C) to 550°F (288°C)
- Heavy gauge welded front frame
- Stainless steel non-clog standing pilot for each burner
- 2 nickel chrome plated oven racks per oven with 3 rack positions
- 6" adjustable stainless steel legs
- Removable drip/crumb tray under the burners
- 4" landing edge for increased plate stability
- Stainless steel high shelf

AVAILABLE EXCLUSIVELY AT BURKETT RESTAURANT EQUIPMENT & SUPPLIES | BURKETT.COM/BRAND/SEAGATE | 419-720-8190



SEAGATE

SPECIFICATIONS

Specifications are subject to change without notice

SGR-4-24



SGR-6-36



SGR-10-60



MODEL NUMBER	SGR-4-24	SGR-6-36	SGR-10-60
NUMBER OF BURNERS	4	6	10
BTU (EACH TOP BURNER)	30,000	30,000	30,000
BTU (OVEN)	32,000	32,000	32,000
TOTAL BTU	152,000	212,000	360,000
OVEN DIMENSIONS (W x D x H)	18" x 26" x 14.25"	26.6" x 22.8" x 14.2"	26.6" x 22.8" x 14.2" (x 2)
EXTERIOR DIMENSIONS (W x D x H)	24" x 32.3" x 56.75"	36" x 32.3" x 56.75"	60" x 32.5" x 50.75"
WEIGHT (lbs)	309	410	725

MODEL NUMBER	SGR-6B-24MG-60
NUMBER OF BURNERS	6
BTU (EACH TOP BURNER)	30,000
BTU (OVEN)	32,000
BTU (GRIDDLE)	39,000
TOTAL BTU	283,000
GRIDDLE DIMENSIONS (W x D)	24" x 20.6"
OVEN DIMENSIONS (W x D x H)	26.6" x 22.8" x 14.2" (x 2)
EXTERIOR DIMENSIONS (W x D x H)	60" x 32.4" x 58.5"
WEIGHT (lbs)	772



SGR-6B-24MG-60

WARRANTY

1-YEAR LIMITED PARTS & LABOR

AVAILABLE EXCLUSIVELY AT BURKETT RESTAURANT EQUIPMENT & SUPPLIES | BURKETT.COM/BRAND/SEAGATE | 419-720-8190



SGR-4-24

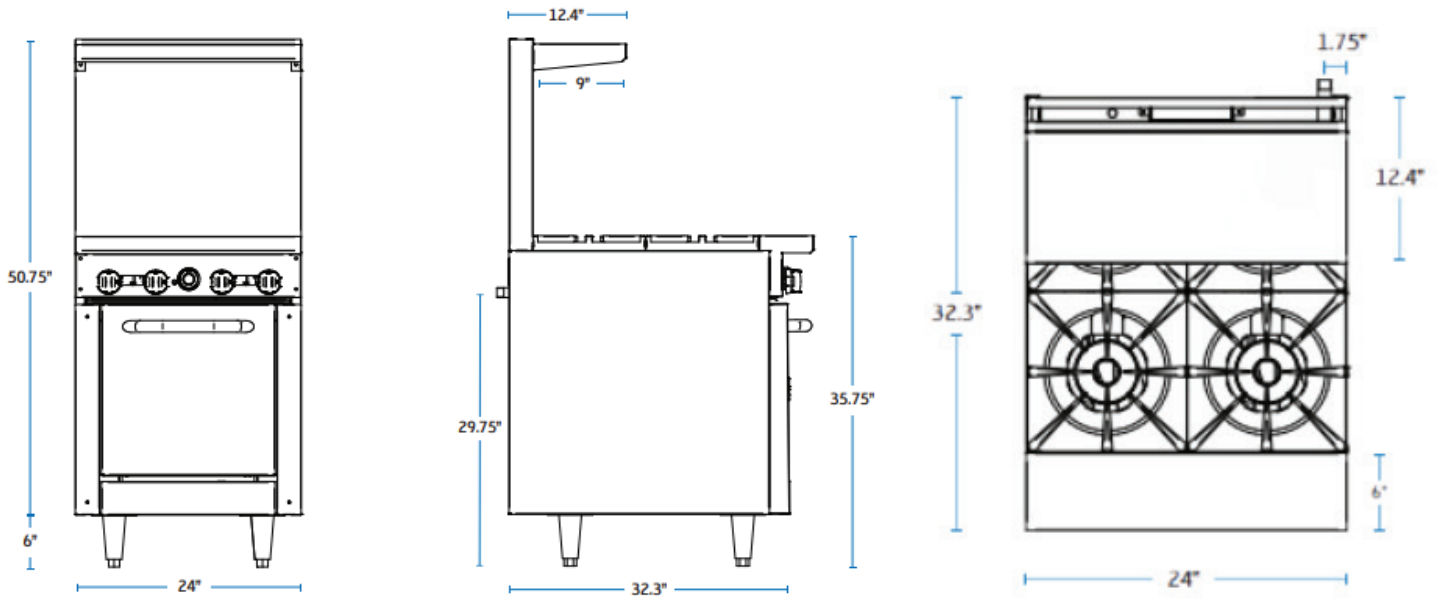

SGR-6-36

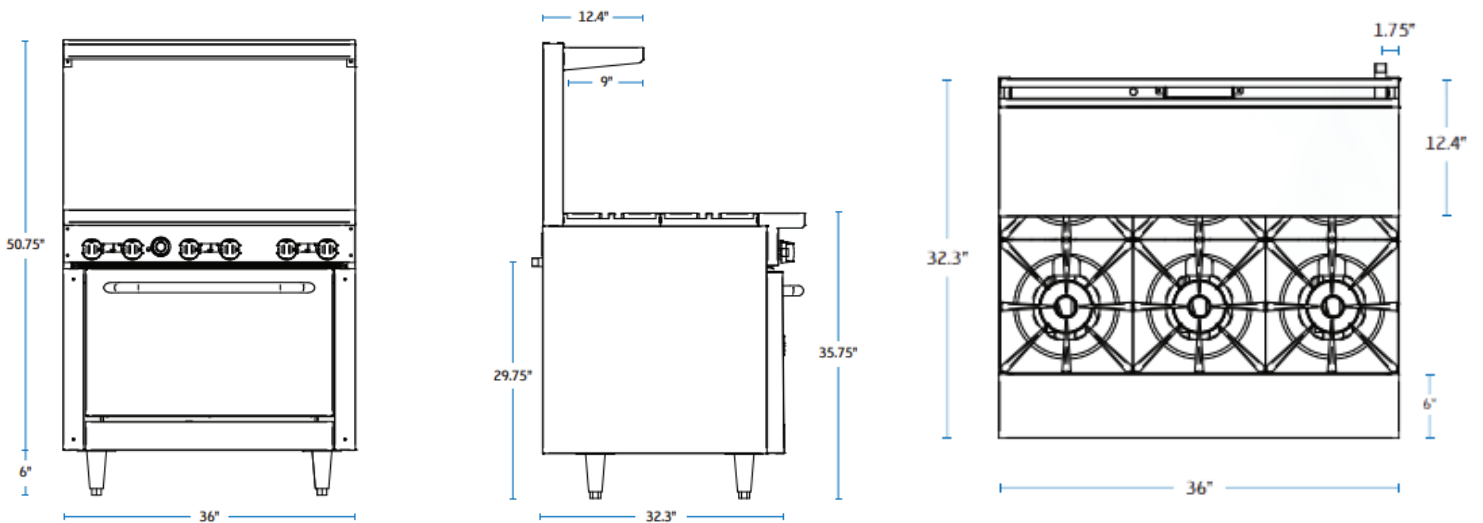



SGR-10-60

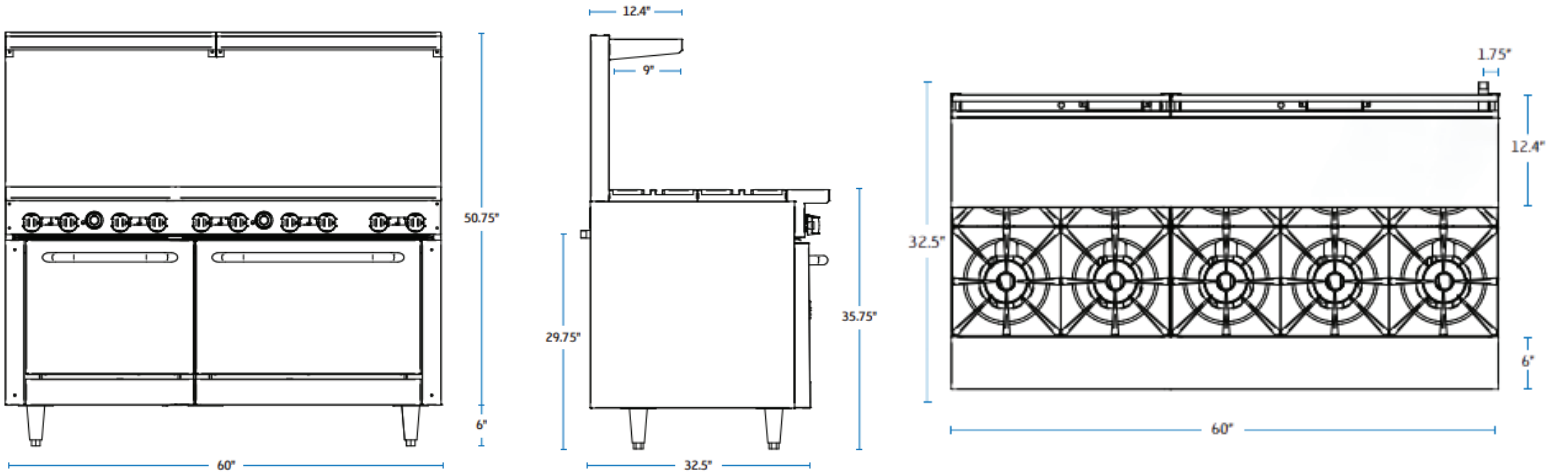

SGR-6B-24MG-60

