

"OSC1F" OVERSHELVES - CANTILEVERED

Single Shelf, 16GA w/Flat Top

FEATURES:

- Stainless Steel Shelf With Stallion Safety Edge On Front And Rear
- 16GA, Type 300 Stainless Steel With #4 Polish, Satin Finish
- Uprights Are 1-1/2" Square 14GA Tubing, Type 300 Stainless Steel With #4 Polish, Satin Finish
- Single Overshelves Are Mounted 18" Above Table Top
- Overshelves Feature Knockdown Setup
- All Models Are Approved By The National Sanitation Foundation

SPECIFICATIONS:

- Stainless Steel Overshelves Are TIG Welded
- Exposed Welds Are Polished To Match Adjacent Surfaces
- Shelf: 16GA, Type 300 Stainless Steel, #4 Polish, Satin Finish
- Uprights: 1-1/2" Round O.D., 14GA Type 300 Tubular Stainless Steel #4 Polish, Satin Finish
- Heat Lamp Provision: OSEHLP-6XX 6=Width Of Provision, XX=Nominal Length Of Shelf

CERTIFICATIONS:



OSC16FK-1236

"OSC1F" CANTILEVERED OVERSHELVES

LENGTH (L)	12" WIDTH	WT (LBS)	18" WIDTH	WT (LBS)
36"	OSC16FK-1236	24	OSC16FK-1836	33
48"	OSC16FK-1248	29	OSC16FK-1848	37
60"	OSC16FK-1260	33	OSC16FK-1860	41
72"	OSC16FK-1272	37	OSC16FK-1872	45
84"	OSC16FK-1284	47	OSC16FK-1884	55
96"	OSC16FK-1296	50	OSC16FK-1896	60
108"	OSC16FK-12108	55	OSC16FK-18108	65
120"	OSC16FK-12120	60	OSC16FK-18120	70
132"	OSC16FK-12132	67	OSC16FK-18132	75
144"	OSC16FK-12144	73	OSC16FK-18144	80

ALL DIMENSIONS ARE TYPICAL. TOLERANCE +/- .500". JOHN BOOS & CO. RESERVES THE RIGHT TO CHANGE SPECIFICATIONS WITHOUT NOTICE.

DETAILED SPECIFICATIONS

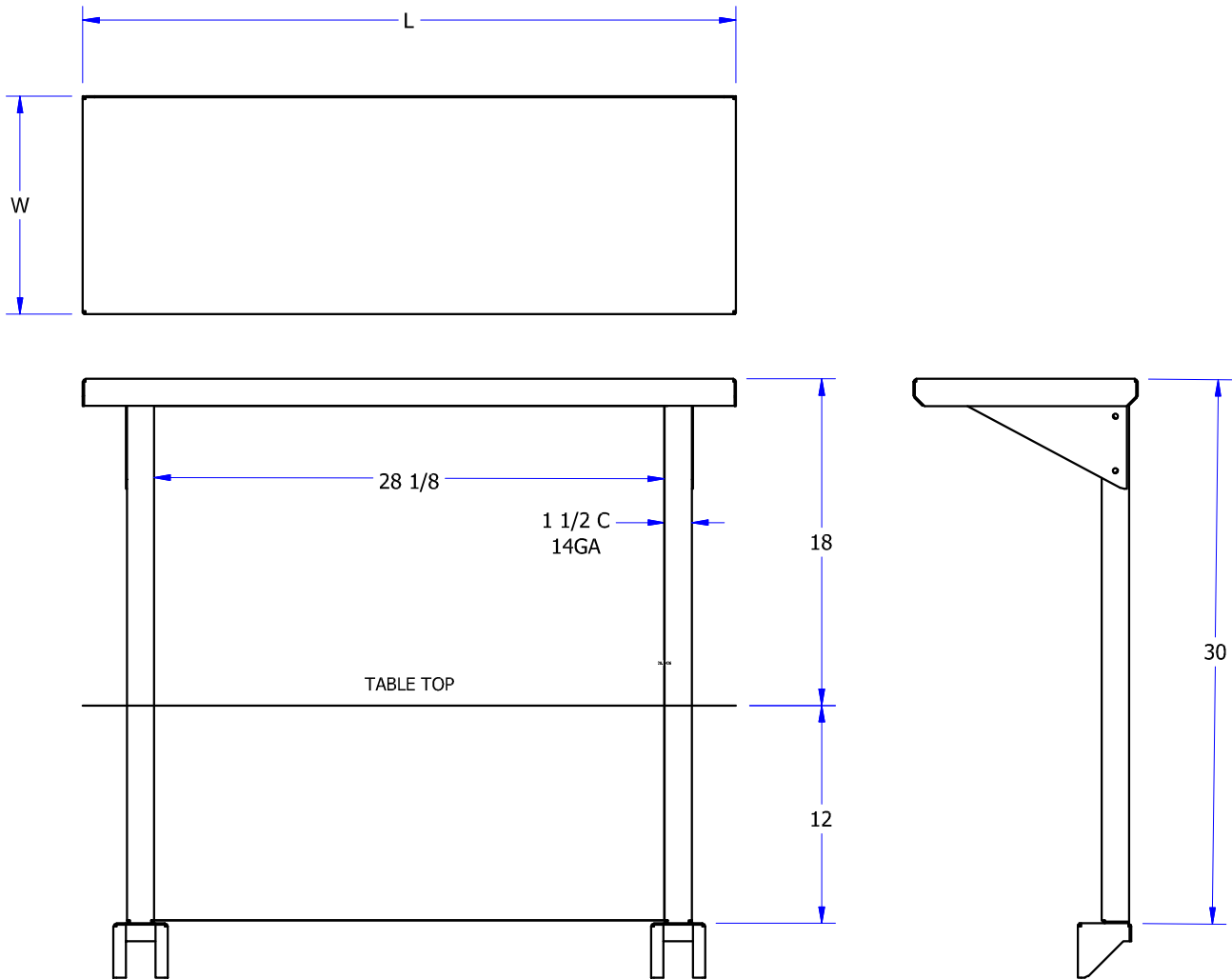

"OSC1F" CANTILEVERED OVERSHELVES

LENGTH (L)	12" WIDTH	WT (LBS)	18" WIDTH	WT (LBS)
36"	OSC16FK-1236	24	OSC16FK-1836	33
48"	OSC16FK-1248	29	OSC16FK-1848	37
60"	OSC16FK-1260	33	OSC16FK-1860	41
72"	OSC16FK-1272	37	OSC16FK-1872	45
84"	OSC16FK-1284	47	OSC16FK-1884	55
96"	OSC16FK-1296	50	OSC16FK-1896	60
108"	OSC16FK-12108	55	OSC16FK-18108	65
120"	OSC16FK-12120	60	OSC16FK-18120	70
132"	OSC16FK-12132	67	OSC16FK-18132	75
144"	OSC16FK-12144	73	OSC16FK-18144	80

ALL DIMENSIONS ARE TYPICAL. TOLERANCE +/- .500". JOHN BOOS & CO. RESERVES THE RIGHT TO CHANGE SPECIFICATIONS WITHOUT NOTICE.