

BKCDT - Right Side S/S Clean Dish Table with Galvanized Legs

- T-304 18 ga Stainless Steel Top
- 10" Backsplash

• 1 5/8" Rolled Edge



Part Number	NSF	Length	Legs & Bracing
BKCDT-26-R	✓	26"	Galvanized
BKCDT-36-R	✓	36"	Galvanized
BKCDT-48-R	✓	48"	Galvanized
BKCDT-60-R	✓	60"	Galvanized
BKCDT-72-R	✓	72"	Galvanized



BKCDT - Right Side S/S Clean Dish Table with S/S Legs



Part Number	NSF	Length	Legs & Bracing
BKCDT-26-R-SS	✓	26"	Stainless
BKCDT-36-R-SS	✓	36"	Stainless
BKCDT-48-R-SS	✓	48"	Stainless
BKCDT-60-R-SS	✓	60"	Stainless
BKCDT-72-R-SS	✓	72"	Stainless

Upgrade To
S/S Legs And
Bracing Use
"-SS" Part #

S/S Legs and Bracing Kit

- Sold separately

Part Number

BKL-DT-SS

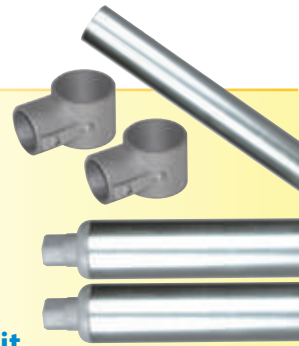

BKCDT - Left Side S/S Clean Dish Table with Galvanized Legs

- T-304 18 ga Stainless Steel Top
- 10" Backsplash

• 1 5/8" Rolled Edge



Part Number	NSF	Length	Legs & Bracing
BKCDT-26-L	✓	26"	Galvanized
BKCDT-36-L	✓	36"	Galvanized
BKCDT-48-L	✓	48"	Galvanized
BKCDT-60-L	✓	60"	Galvanized
BKCDT-72-L	✓	72"	Galvanized

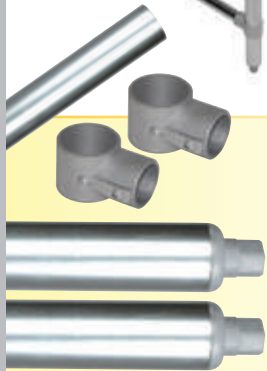

Upgrade To
S/S Legs And
Bracing Use
"-SS" Part #

S/S Legs and Bracing Kit

- Sold separately

Part Number

BKL-DT-SS

BKCDT - Left Side S/S Clean Dish Table with S/S Legs



Part Number	NSF	Length	Legs & Bracing
BKCDT-26-L-SS	✓	26"	Stainless
BKCDT-36-L-SS	✓	36"	Stainless
BKCDT-48-L-SS	✓	48"	Stainless
BKCDT-60-L-SS	✓	60"	Stainless
BKCDT-72-L-SS	✓	72"	Stainless