

# Mobile Soup & Salad Kiosk

## Standard Features

**FRAME:** Featuring frameless construction utilizing 16 gauge stainless steel formed end panels with top and bottom horizontal members of 16 gauge stainless steel.

**CASTERS:** Heavy duty 5" diameter plate casters with gray rubber tires. Brake models to be supplied on all casters.

**TOP:** 14 gauge stainless steel with 2" turndown on all sides and sound deadening applied between top and frame.

**FRONT BODY PANEL:** Plastic laminate or stainless steel panels.

**CONTROL PANEL:** All switches to be centrally located in common control panel assembly.

**SOUP WELLS:** 7 quart soup well. 120 volt 800 watt unit.

**INSULATED DRINK/SALAD BIN:** Insulated deep ice bin for cold drinks with removable divider/filler to accommodate pre-made salads and dressings.

**STAINLESS STEEL SPECIFICATION:** All stainless steel to be type 304 with number 4 finish.

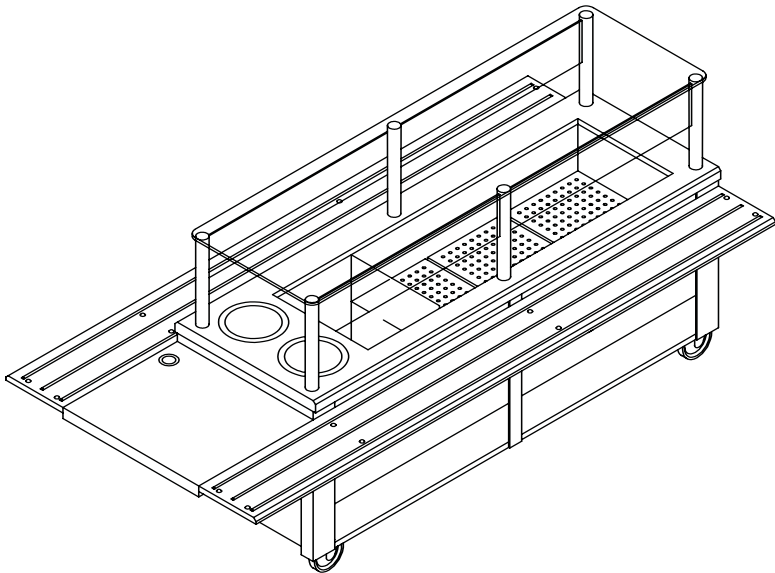

MODEL	LENGTH	WIDTH	HP	VOLTS	PHASE	AMPS	NEMA CORD/CAP	APPROX. SHIP WEIGHT
MCT-SBKS	105"	-	-	120	1	18.4	NEMA 5-20P	915 lbs



2320 Peyton Houston, Texas 77032  
 Phone 281-442-8001 Toll Free: 888-955-5463 Fax: 281-442-3351 [www.mod-u-serve.com](http://www.mod-u-serve.com)

MUS.22 11/05

# Mobile Soup & Salad Kiosk

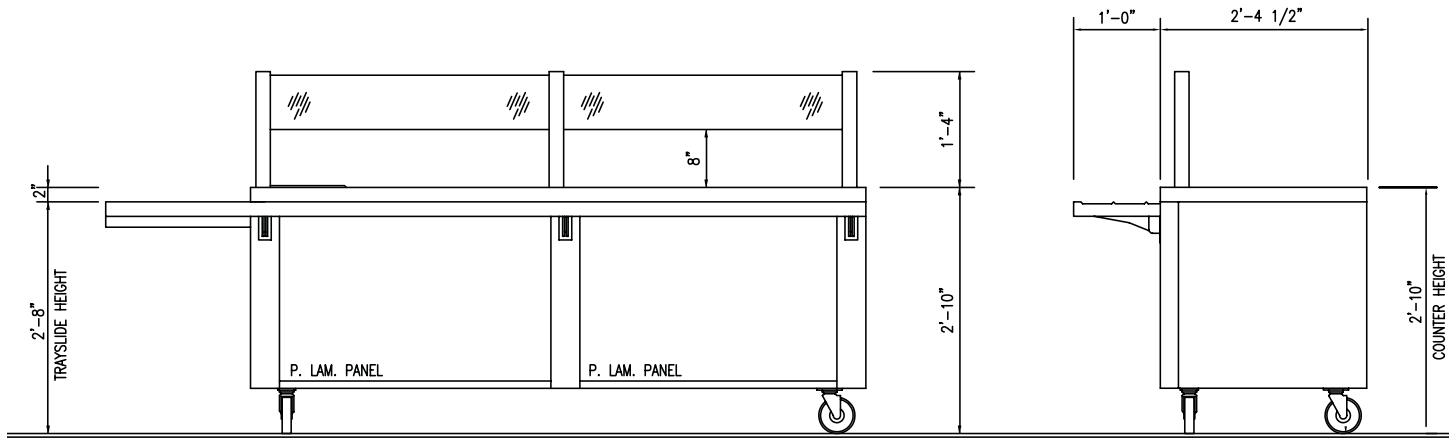

## Optional Features

**TRAYSLIDE:** Stainless steel or Corian® trayslide mounted on fold down brackets.

**FRONT BODY PANEL:** Ceramic tile front panels.

**CANOPY:** Canvas canopy.

**SERVING SHELF OR SNEEZEGUARD:** 16 gauge stainless steel or Corian® serving shelf with sneezeguard. Custom sneezeguard also available.

**CASHIER SHELF:** 14 gauge stainless steel fixed shelf with cord grommet in top for access to electrical outlet below.



Mod-U-Serve reserves the right to modify specifications or discontinue models without notice or incurring obligation.



2320 Peyton Houston, Texas 77032

Phone 281-442-8001 Toll Free: 888-955-5463 Fax: 281-442-3351 [www.mod-u-serve.com](http://www.mod-u-serve.com)

MUS.22 11/05