



BEVERAGE-AIR

| | |
|-----------------|------------|
| Project: _____ | AIA# _____ |
| Item: _____ | |
| Location: _____ | SIS# _____ |
| Approved: _____ | |

REACH-IN / PASS-THRU REFRIGERATORS

RID18HC Half Solid Door Bottom Mount
Hydrocarbon Series

MODEL:
RID18HC-HS



RID18HC-HS

3 Year Parts/Labor Warranty
Additional 4 Year Compressor Warranty

CABINET CONSTRUCTION

- Stainless steel exterior and interior
- Full electronic control
- Interior LED Light
- Three (3) shelves per section standard
- One piece grille
- Cartridge style hinges
- 120° hold open feature
- Snap-in magnetic door gasket
- Anti-Microbial door handles
- 3" heavy duty casters with two brakes standard

OPTIONS & ACCESSORIES

- Epoxy shelves & clips
- 6" casters or 6" leg optional
- Wire shelf dividers
- Right or left hinged door
- Remote option (see note on back page)

REFRIGERATION SYSTEM

- Uses environmentally friendly, energy efficient R290 refrigerant, and meets all regulatory requirements for CARB, SNAP, DOE & more
- Adaptive Defrost
- Epoxy coated evaporator coil
- Maintains temperature between 36° and 38°F

RID18HC BOTTOM MOUNT REACH-INS: PASS-THRU SERIES



3779 Champion Blvd., Winston-Salem, NC 27105
1-888-845-9800 Fax: 1-336-245-6453
Beverage-Air.com Sales@bevair.com



BEVERAGE-AIR

Bottom Mount Reach-In

Models: RID18HC-HS

| MODEL | RID18HC-HS |
|----------------------------------|------------------------|
| EXTERNAL DIMENSIONAL DATA | |
| Width Overall | 27 1/4" |
| Depth Overall | 32 5/8" |
| Height Overall with Casters | 72 3/8" |
| Number of Doors | 4 |
| Depth with Door Open 90° | 80 1/8" |
| Drawer Opening (inches) | 24" x 24 3/4" |
| INTERNAL DIMENSIONAL DATA | |
| NET Capacity (cubic ft.) | 18.38 |
| Internal Width Overall (in) | 24 1/4" |
| Internal Depth Overall (in) | 25 1/8" |
| Internal Height Overall (in) | Max 53" Min 46 5/8" |
| Number of Shelves | 4 |
| ELECTRICAL DATA | |
| Full Load Amperes 115/60/1 | 5.5 |
| REFRIGERATION DATA | |
| Horsepower | 1/4 |
| Capacity (BTU/Hr)* | 1997 |
| SHIPPING DATA | |
| Gross - Crated | 422 lbs |
| Height - Crated | 76" |
| Width - Crated | 30" |
| Depth - Crated | 35" |

*NOTE: Remote units are field wired and come with 6" legs. Refrigerant must be specified at time of order.

Model Views

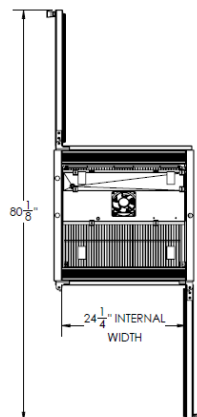

Plan View

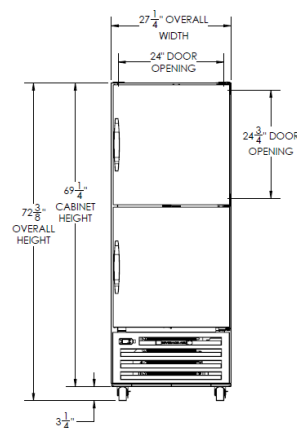

Elevation View

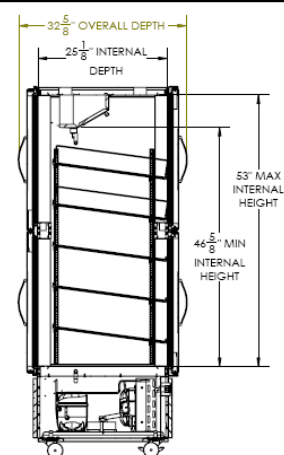

Side View

ELECTRICAL CONNECTION



115/60/1
NEMA-5-15P

Unit pre-wired at
factory and include 8'
long cord and plug set.



3779 Champion Blvd., Winston-Salem, NC 27105 1-888-845-9800 Fax: 1-336-245-6453 Beverage-Air.com Sales@bevair.com

an Ali Group Company



The Spirit of Excellence