



BEVERAGE-AIR

Project: _____	AIA# _____
Item: _____	
Location: _____	SIS# _____
Approved: _____	

MARKETEER™ MERCHANDISERS

MT21 Black Hinged Door Model
Hydrocarbon Series

MODEL:
MT21-1B

MT21™ MERCHANDISER: HINGED DOOR MODEL

3 Year Parts/Labor Warranty
Additional 4 Year Compressor Warranty

CABINET CONSTRUCTION

- Standard cabinet exterior finish is black heavy duty pre-painted steel
- Heavy duty interior construction includes white coated steel
- Electronic temperature control
- Modern one piece grill
- Double pane lowE argon filled glass doors feature outside pane that is tempered for added safety
- Self-closing hinged glass door features, pocket door handle
- LED lighting
- Four (4) epoxy coated shelves per door section.
- 2" Leveling feet

REFRIGERATION SYSTEM

- Uses environmentally friendly, energy efficient R290 refrigerant, and meets all regulatory requirements for CARB, SNAP, DOE & more
- Condenser is designed to be low maintenance, and energy efficient.
- Automatic, non-electric defrost
- Epoxy coated evaporator coil



Please verify qualifying units by visiting:
www.energystar.gov/cfs

3779 Champion Blvd., Winston-Salem, NC 27105
1-888-845-9800 Fax: 1-336-245-6453
Beverage-Air.com Sales@bevair.com



BEVERAGE-AIR

MODEL	MT21-1B
EXTERNAL DIMENSIONAL DATA	
Width Overall	39 1/6"
Depth Overall	24 1/2"
Height Overall	61 1/4"
Number of Doors	2
Depth with Door Open 90 °	35 7/8"
INTERNAL DIMENSIONAL DATA	
NET Capacity (cubic ft.)	16.8
Capacity 20 oz.	Flat 180 Gravity 165
Internal Width Overall (in)	36 1/8"
Internal Depth Overall (in)	17 3/4"
Internal Height Overall (in)	39 3/4"
Number of Shelves	4
ELECTRICAL DATA	
Full Load Amperes 115/60/1	3.33
REFRIGERATION DATA	
Horsepower	1/4+
Energy Consumption	2.900 kWh/day
SHIPPING DATA	
Gross Weight - Crated	254 lbs
Height - Crated	64 1/4"
Width - Crated	42 1/2"
Depth - Crated	28"

Glass Hinged Door Model

Model: MT21-1B

Model Views

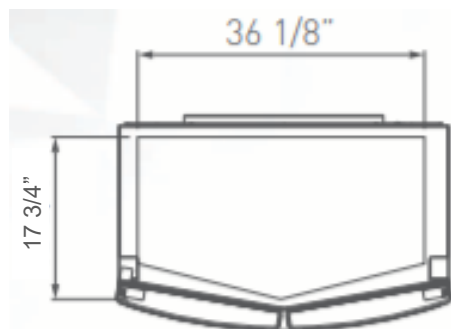

Plan View

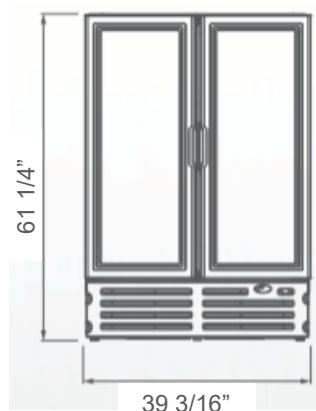

Elevation View

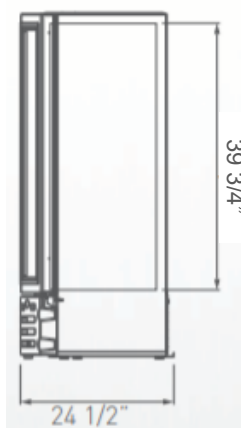

Side View

ELECTRICAL CONNECTION



115/60/1
NEMA-5-15P

Units pre-wired at
factory and include 8'
long cord and plug set.



3779 Champion Blvd., Winston-Salem, NC 27105 1-888-845-9800 Fax: 1-336-245-6453 Beverage-Air.com Sales@bevair.com

an Ali Group Company



The Spirit of Excellence