

## GENERAL INFORMATION

**Project Name:** \_\_\_\_\_  
**Item:** \_\_\_\_\_  
**Quantity:** \_\_\_\_\_  
**Model:** DECO-320-N  
**Length:** \_\_\_\_\_

## GENERAL SPECIFICATION

### Materials

- 1" x 2" Stainless Steel Rectangle Tubing Uprights
- Tempered Glass Front and Top
- Polished Exposed Glass Edges
- Stainless Mounting Flange

### Construction

- Maximum Post Spacing
  - 42" with 1/4" Glass
  - 72" with 1/2" Glass
- NSF Standard 2 Construction
- Shipped Fully Assembled
- Rear Posts on Ends Only

## TUBE OPTIONS

☐ 1-1/2" Square

## TUBE FINISH

- ☐ #4 Brushed Stainless Steel  
☐ #8 Mirror Polished Stainless Steel  
☐ Powder Coated - Color \_\_\_\_\_

## GLASS OPTIONS

- ☐ 1/4" Tempered Glass  
☐ 1/2" Tempered Glass  
☐ 3/8" Tempered Glass  
☐ Full Perimeter Channel  
☐ 1/4" Tempered Glass End Panel

## FRONT GLASS OPTIONS

☐ Adjustable Half Height Upper Glass Self-Serve

## TOP SHELF OPTIONS

- ☐ 1/2" Tempered Glass  
☐ 3/8" Tempered Glass  
☐ #8 Mirror Polished Brass  
☐ Stainless: ☐ #4 Brushed ☐ #8 Mirror Polished  
☐ Powder Coated Color \_\_\_\_\_  
☐ Solid Surface Material Color \_\_\_\_\_

## \* Approval Drawings Required

Printed in the U.S.A. (December 2018) BSI, LLC  
 Specifications subject to change without notice.

## DECO-320-N

### Operator-Serve Food Shield

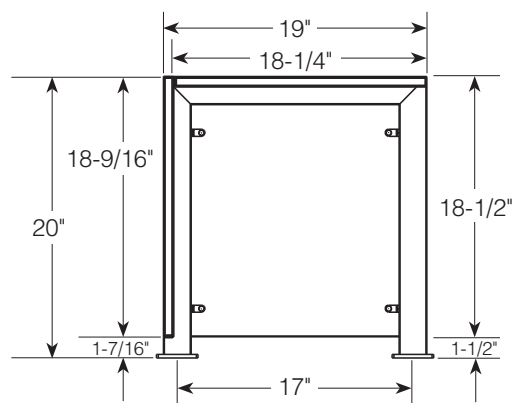

To meet NSF guidelines, end panels are included on all BSI quotations unless specifically excluded.

## LIGHT AND WARMER OPTIONS

- ☐ LED Light Unit  
☐ Linear T-5 Fluorescent Unit  
☐ BSI Stealth™ Linear Heat Only Unit  
☐ BSI Stealth™ Linear Heat and Light Combo Unit (Fluorescent)  
☐ BSI Stealth™ Linear Heat and Light Combo Unit (LED)  
☐ BSI Stealth™ Linear Double Heat and Light Combo Unit (Fluorescent)  
☐ BSI Stealth™ Linear Double Heat and Light Combo Unit (LED)  
☐ Hatco® Brand Heat Only Unit  
☐ Hatco® Brand Heat and Light Combo Unit