

## SCI & SCI-NU

### Mobile Ice Pan Serving Counters

#### Models

- SCI-36 - 26" x 21.62" ice pan, with understorage
- SCI-50 - 39" x 21.62" ice pan, with understorage
- SCI-60 - 52" x 21.62" ice pan, with understorage
- SCI-74 - 65" x 21.62" ice pan, with understorage
- SCI-96 - 78" x 21.62" ice pan, with understorage
- SCI-36-NU - 26" x 21.62" ice pan, without understorage
- SCI-50-NU - 39" x 21.62" ice pan, without understorage
- SCI-60-NU - 52" x 21.62" ice pan, without understorage
- SCI-74-NU - 65" x 21.62" ice pan, without understorage
- SCI-96-NU - 78" x 21.62" ice pan, without understorage



SCI-36-NU

#### Standard Features

- 18-gauge stainless steel exterior body
- 14-gauge galvanized bottom
- Line-up interlock device
- Best for use where electricity is not available
- Insulated ice pan is 7" deep and is standard with the following: perforated false bottom, drain with valve and casters
- SCI units are standard with dry hinged door storage compartment, while SCI-NU units have enclosed bases with no under storage
- All exterior panels reinforced with overlapping corners, welded in place
- All body cutouts reinforced with 14-gauge channel supports
- All units are standard on 5" diameter polyurethane swivel casters for easy cleaning
- Easy to use stainless steel interlock system is standard on base and tray slides
- Two year parts and labor standard warranty

#### Options & Accessories

- Adjustable height casters
- Tray slide and work shelves
- Composite fold-down cutting boards
- Glass-front counter protector
- FlexiShield® Food Shields
- 18-gauge stainless steel overshell
- Fluorescent or incandescent light fixtures\*
- Laminate door panel insert (SCI Series only)
- Open understorage with shelf (SCI-NU Series only)
- 120V/60Hz/1Ø, 10 amp convenience outlet with breaker\*
- Dry insert with doors (SCI-NU units only)
- Refrigerated understorage (60" unit or longer)\*
- Stainless steel trim strips
- Stainless steel end drop shelf
- 6" (15.2cm) high adjustable stainless steel legs in lieu of casters
- Laminate exterior panels in lieu of stainless steel exterior panels

\* Inclusion of these options will alter the electrical specifications of unit

#### Specifications

**Exterior body** is constructed of 18-gauge stainless steel side panels and 14-gauge galvanized bottom. All exterior side panels are reinforced with overlapping corners and are welded in place. All body cutouts are reinforced with 14-gauge galvanized channel supports.

**Exterior top** is constructed of 14-gauge stainless steel, welded, ground and polished into one integral unit. Top is fabricated with square exterior corners.

**Insulated ice pan** is 7" (18cm) deep and constructed of 22-gauge stainless steel. A removable, perforated false bottom 1" (2.5cm) high, constructed of stainless steel, is supplied. The ice pan is separated from the exterior top by a Therma Brake and fully insulated with environmentally friendly, Kyoto Protocol Compliant, Non ODP (Ozone Depletion Potential), Non GWP (Global Warming Potential) foam in place polyurethane insulation. Ice pan is equipped with a 1" (2.5cm) I.P.S. drain plumbed to drain valve located at the bottom of the unit.

**Casters:** unit is mounted on 5" (13cm) diameter swivel casters with non-marking two locking and two non-locking polyurethane tires. Overall height of caster assembly is 6" (15cm).

**SCI Series units only** have a two-door dry compartment(s) constructed of 18-gauge stainless steel. Each compartment is equipped with a stainless steel shelf; doors are double-wall construction, with stainless steel front panel.



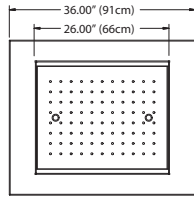

Plan View, SCI-36(-NU)

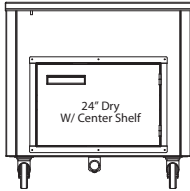

Elevation View, SCI-36

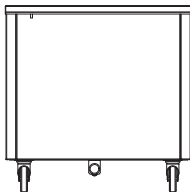

Elevation View, SCI-36-NU

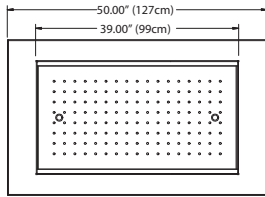

Plan View, SCI-50(-NU)

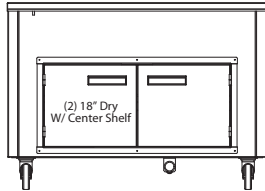

Elevation View, SCI-50

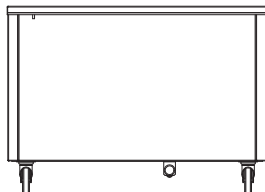

Elevation View, SCI-50-NU

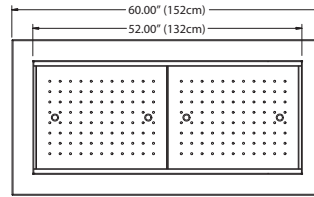

Plan View, SCI-60(-NU)

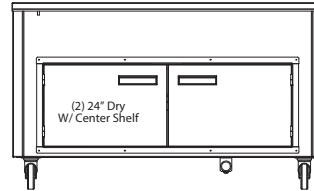

Elevation View, SCI-60

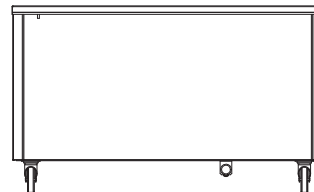

Elevation View, SCI-60-NU

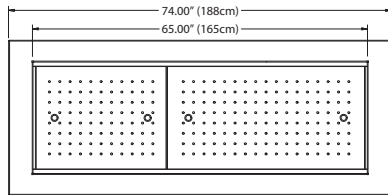

Plan View, SCI-74(-NU)

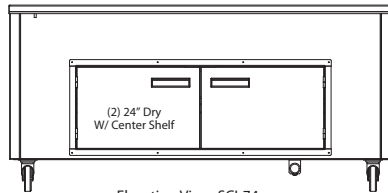

Elevation View, SCI-74

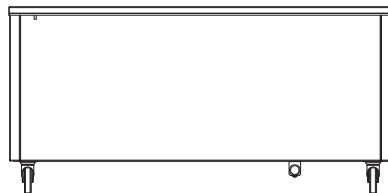

Elevation View, SCI-74-NU

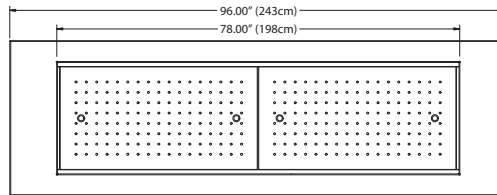

Plan View, SCI-96(-NU)

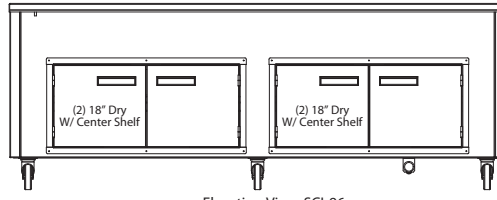

Elevation View, SCI-96

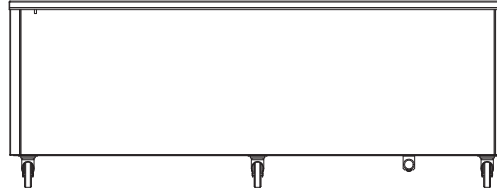

Elevation View, SCI-96-NU

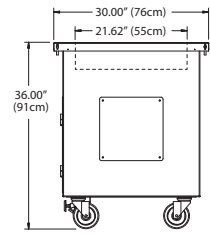

Side View, All Models

Specifications					
Model	# Of Doors	# Of Shelves	Ship Weight	Model	Ship Weight
SCI-36	1	1	240 lbs/109 kg	SCI-36-NU	200 lbs/91 kg
SCI-50	2	1	285 lbs/129 kg	SCI-50-NU	245 lbs/111 kg
SCI-60	2	1	320 lbs/145 kg	SCI-60-NU	280 lbs/127 kg
SCI-74	2	1	360 lbs/163 kg	SCI-74-NU	330 lbs/150 kg
SCI-96	4	2	400 lbs/181 kg	SCI-96-NU	380 lbs/172 kg

Delfield reserves the right to make changes to the design or specifications without prior notice.