

Item #: _____ Qty #: _____
 Model #: _____
 Project #: _____

DTA-79

TABLE MOUNTED TUBULAR, DOUBLE SIDED DESIGN



Recommended for D, G and U-Shaped Series Dishtables Only.

FEATURES:

A dual purpose double sided open tubular design table mounted rack shelf with solid end plates

CONSTRUCTION:

Stainless steel posts, cross-tubes & end plates
 Mounts to dishtable with stainless steel bolts. Ships Knocked Down*
 Easily assembles with simple tool

MATERIAL:

End Plates are 14 gauge type 304 series stainless steel
 Tubing is 1 5/8" diameter 18 gauge type 300 stainless steel tubing

*Shelf ships separately from table to reduce freight costs and chance of shipping damage. Entire unit may ship pre-assembled from factory where special applications exist. Consult factory.
 Per Linear Foot. Minimum Length 48"



OPTION 1: Lower Angle
 (Racks cannot be back to back)

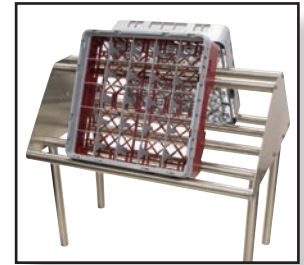

OPTION 2: Higher Angle
 For back to back storage
 (For maximum rack storage)

When using DTA-79 as a Pass-Thru for a glass rack, use **OPTION 2** (see above).
 This will allow the rack to pass through the middle (10" Clearance).



OPTIONAL
12" Wide Solid Overshelf
Model # DTA-80
 Mounts above DTA-79
 (Quantity must be equal to the length of DTA-79)
 Sold per linear foot

MODEL #	Qty.
DTA-79	

DTA-79S

TABLE MOUNTED, DOUBLE SIDED DESIGN WITH SOLID BASE

FEATURES:

Table mounted rack shelf with solid base & end plates.
 Drip tubes for water drainage

CONSTRUCTION:

Stainless steel posts, cross-tube (at top along length) & end plates
 Mounts to dishtable with stainless steel bolts. Ships Knocked Down*
 Easily assembles with simple tool

MATERIAL:

End Plates and shelf base are 14 gauge type 304 series stainless steel
 Tubing is 1 5/8" diameter 18 gauge type 300 stainless steel tubing

*Shelf ships separately from table to reduce freight costs and chance of shipping damage. Entire unit may ship pre-assembled from factory where special applications exist. Consult factory.
 Per Linear Foot. Minimum Length 48"



OPTIONAL
12" Wide Solid Overshelf
Model # DTA-80
 Mounts above DTA-79
 (Quantity must be equal to the length of DTA-79)
 Sold per linear foot

MODEL #	Qty.
DTA-79S	

DIMENSIONS and SPECIFICATIONS

TOL ± .125"

ALL DIMENSIONS ARE TYPICAL

DTA-79

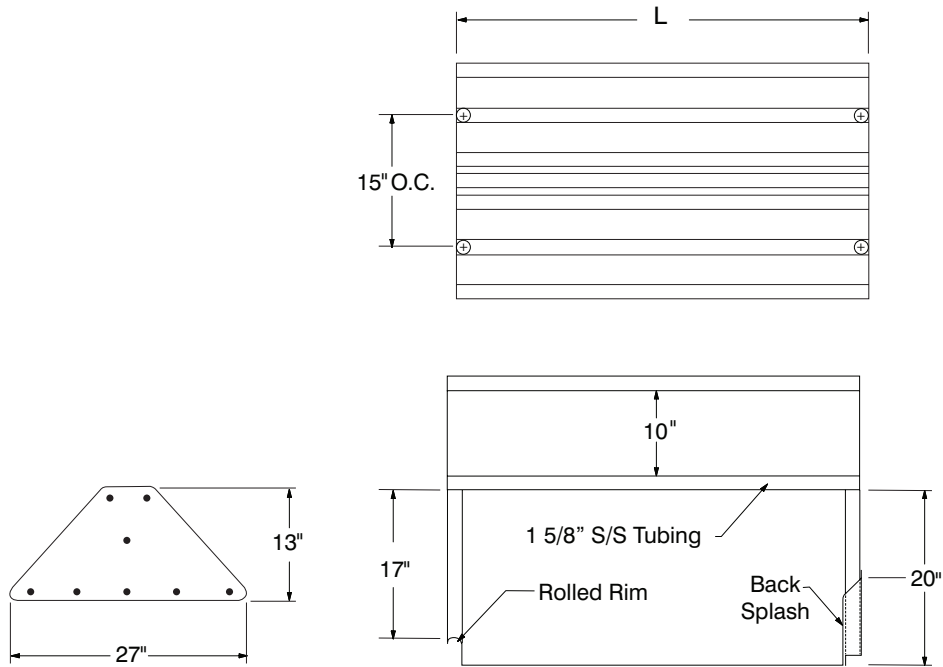

DTA-79S

