

GENERAL INFORMATION

Project Name: _____
Item: _____
Quantity: _____
Model: XG3500-2
Length: _____

STANDARD NSF LISTED FINISH OPTIONS

- | | |
|---|--|
| <input type="checkbox"/> Brushed Aluminum | <input type="checkbox"/> Chrome |
| <input type="checkbox"/> Gloss Black | <input type="checkbox"/> Wrinkle Black |
| <input type="checkbox"/> Smoked Copper | <input type="checkbox"/> Polished Brass Finish |
| <input type="checkbox"/> Other _____ | |

GLASS OPTIONS

- | |
|--|
| <input type="checkbox"/> 1" Radius Corner (standard) |
| <input type="checkbox"/> Square Corners |
| <input type="checkbox"/> 1/4" Tempered Glass (not for shelves)
Centerline Max 54" |
| <input type="checkbox"/> 3/8" Tempered Glass (for shelf or span more than 54")
Centerline Max 66" |
| <input type="checkbox"/> 1/2" Tempered Glass (for shelf or span more than 66")
Centerline Max 72" |

INSTALLATION OPTIONS

Above-Counter: Stainless Steel Counter

Under-Counter: Stainless Steel Counter

(Requires Under-Counter Reinforcement & Access)

Above-Counter: Millwork Counter

Under-Counter: Millwork Counter

See Installation Page for More Details.

XG3500-2

Self-Serve w/Top Shelf or Two-Tier Display Shelf

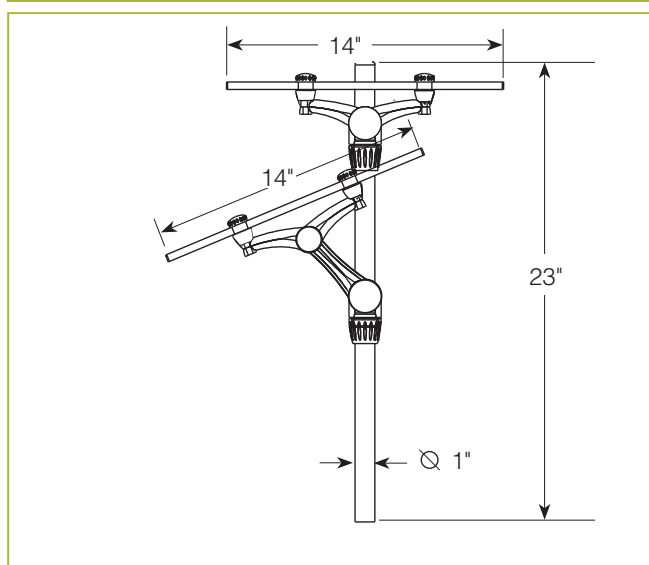

To meet NSF guidelines, end panels are included on all BSI quotations unless specifically excluded. (See End Panel Page for More Details.)

☐ SS1: EZ Mount 2" x 8" Flange

☐ SSU3-H: Heavy-Duty Flange

☐ SSU3-N: Narrow Flange

☐ SSU5-H: Heavy-Duty Flange

☐ SSU5-N: Narrow Flange

☐ MW1: Heavy-Duty Flange

☐ MW2: Narrow Flange

☐ MWU3: Narrow Flange

☐ MWU4: Compression Installation (not recommended for solid surfaces)

☐ MWU5: Heavy-Duty Flange

* Approval Drawings Required

Printed in the U.S.A. (December 2018) BSI, LLC
 Specifications subject to change without notice.

Patent Number US 8,403,430 B2

Rv. 12

