



Chef Tables - Maple Bakers Top with 4" Coved Riser

Stainless Steel Cabinet Base Tables - Sliding Doors

Certifications:



Features:

- 1 5/8" x 6" Straight S/S Leg
- 4" Coved Riser and Sides
- Sliding Doors
- Legs Adjust 1" in Height
- 96" Units have a Center Mullion with Two Sets of 48" Doors
- Extra Supporting "C" Channels
- Casters Available

Material:

- Hard Maple Bakers Top
- T-304 18 ga. Stainless Steel Body
- Stainless Steel Legs & Feet

Options:

- Adjustable Shelf



Sliding Doors	Unit Size (W x L x H)
CMBT-3648S	36" x 48" x 39"
CMBT-3660S	36" x 60" x 39"
CMBT-3672S	36" x 72" x 39"
CMBT-3696S*	36" x 96" x 39"

* Has a Center Mullion

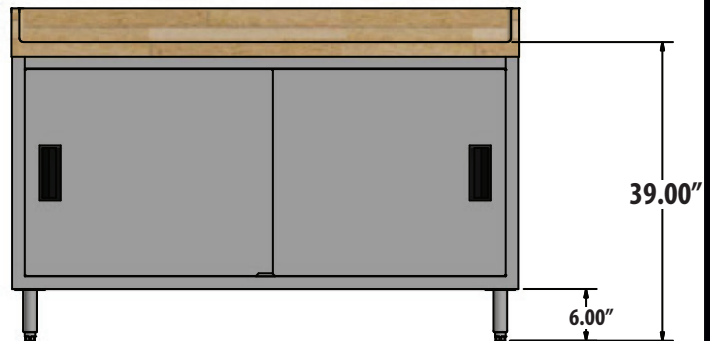
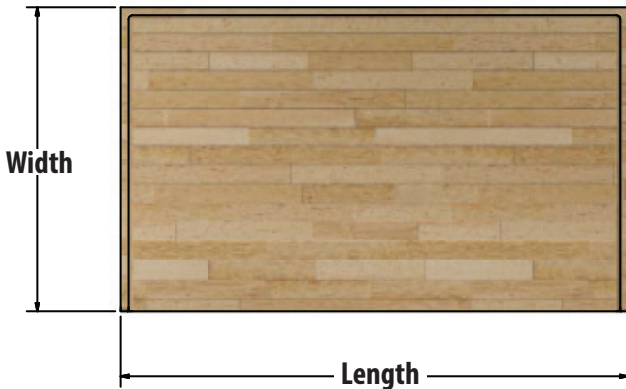

PRODUCT DATA SHEET

BK RESOURCES

