

## GENERAL INFORMATION

**Project Name:** \_\_\_\_\_  
**Item:** \_\_\_\_\_  
**Quantity:** \_\_\_\_\_  
**Model:** ZG9500-4  
**Length:** \_\_\_\_\_

## STANDARD NSF LISTED FINISH OPTIONS

- |   |  |
|---|--|
| <input type="checkbox"/> Brushed Aluminum | <input type="checkbox"/> Chrome                |
| <input type="checkbox"/> Gloss Black      | <input type="checkbox"/> Wrinkle Black         |
| <input type="checkbox"/> Smoked Copper    | <input type="checkbox"/> Polished Brass Finish |
| <input type="checkbox"/> Other _____      |  |

## GLASS OPTIONS

- |  |
|--|
| <input type="checkbox"/> 1" Radius Corner (standard)   |
| <input type="checkbox"/> Square Corners  |
| <input type="checkbox"/> 1/4" Tempered Glass (not for shelves)<br>Centerline Max 54"                 |
| <input type="checkbox"/> 3/8" Tempered Glass (for shelf or span more than 54")<br>Centerline Max 66" |

## INSTALLATION OPTIONS

**Above-Counter:** Stainless Steel Counter

**Under-Counter:** Stainless Steel Counter

(Requires Under-Counter Reinforcement & Access)

**Above-Counter:** Millwork Counter

**Under-Counter:** Millwork Counter

**See Installation Page for More Details.**

☐ SS1: EZ Mount 2" x 8" Flange

☐ SSU3-H: Heavy-Duty Flange

☐ SSU3-N: Narrow Flange

☐ SSU5-H: Heavy-Duty Flange

☐ SSU5-N: Narrow Flange

☐ MW1: Heavy-Duty Flange

☐ MW2: Narrow Flange

☐ MWU3: Narrow Flange

☐ MWU4: Compression Installation (not recommended for solid surfaces)

☐ MWU5: Heavy-Duty Flange

## ZG9500-4

*Operator-Serve and/or Partition*

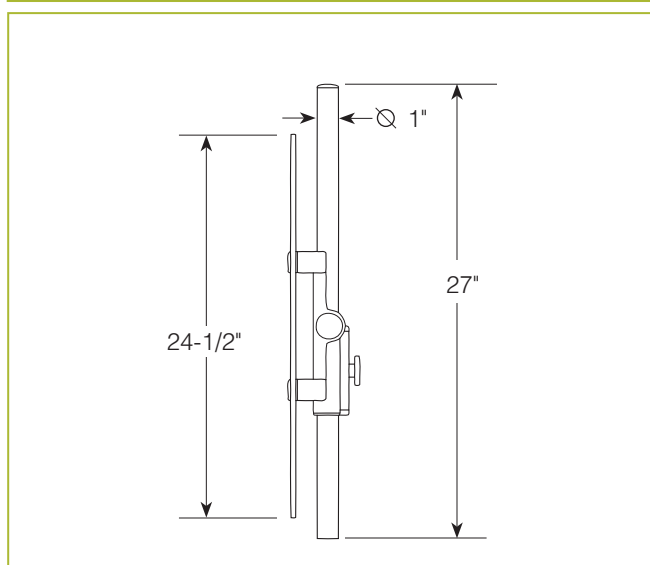
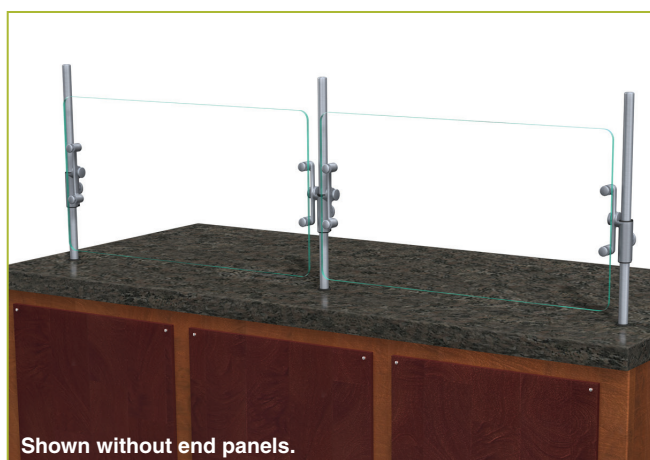

To meet NSF guidelines, end panels are included on all BSI quotations unless specifically excluded. (See End Panel Page for More Details.)

## \* Approval Drawings Required

Printed in the U.S.A. (August 2017) BSI, LLC  
 Specifications subject to change without notice.

Patent Number 6,588,863 Rv. 12

