

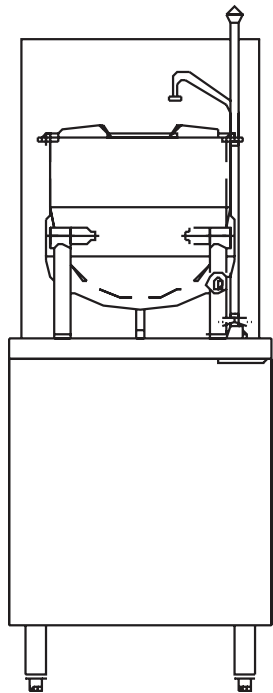

## DIRECT STEAM KETTLE ON GAS BOILER BASE



### SPECIFICATIONS:

Shall be a Crown model \_\_\_\_\_, consisting of a direct connected steam, tilting kettle. A double wall kettle interior shall form a steam jacket around the lower 2/3 of the kettle. The bottom of the kettle shall be of hemispherical design for superior heat circulation. The kettle interior shall be of 316 stainless steel for high acid content products. The stainless steel mounting legs shall have the steam supply and condensate within the legs and the right leg fitted with a steam control valve for the kettle. The kettle shall be fitted with a tilt handle and heat resistant knob, allowing the kettle to be tilted forward past 90° for complete emptying.

The kettle shall be mounted on a cabinet base with full perimeter angle frame, reinforced counter, hot and cold water faucet with control valves, 3" (76 mm) deep sinks with drain, grate and splash guard, gas boiler with controls, hinged door with magnetic catch, removable side panels and 6" (152 mm) stainless steel legs fitted with 4 adjustable flanged feet for securing to the floor, all #4 stainless steel exterior with aluminized steel back. Steam manifolds concealed within cabinet are fitted with a safety relief valve and a steam trap for each kettle. The kettles and boiler shall be ASME code stamped and National Board registered. Water treatment system, electronic ignition, nickel plating, CSD-1 boiler controls, and split water line come standard.

**\*SEE REVERSE SIDE OF SPEC SHEET FOR WATER TREATMENT SYSTEM STATEMENTS\***

MODEL	DESCRIPTION	CAPACITY	
		GALLON	LITER
GMT-6	6 gallon kettle on 24' gas boiler base	6	23
GMT-10	10 gallon kettle on 24' gas boiler base	10	38

### OPERATION SHALL BE BY:

Gas operated 15 psi (103 kPa) steam boiler for operation on 115 VAC, 1 phase, 50/60 Hz rated at 200,000 BTU.

- ☐ Natural Gas
- ☐ LP Gas

### STANDARD FEATURES:

- Water Treatment System
- Electronic ignition
- CSD-1 boiler controls
- Split water line

### OPTIONAL ITEMS AT EXTRA COST:

- ☐ 220-240 VAC operation (specify voltage)(GBVS-1)
- ☐ Etched gallon markings (GM-)
- ☐ Etched litre markings (LM-)
- ☐ Stainless steel rear panel (SSB-24)
- ☐ Stainless steel frame (SSF-24)
- ☐ Correctional package
- ☐ One piece stainless steel lift off cover (C-).
- ☐ Lift-out perforated stainless steel basket (SSB-).
- ☐ Steam take off kit (STOK).
- ☐ Pour lip strainer (TKS-).
- ☐ Water in "Y" strainer (condenser feed)



**REAR FLANGED FOOT DETAIL**

2 EQUALLY SPACED  
 $\phi 7/16"$  [11mm] HOLES  
 ON 2.5" [63mm] B.C.

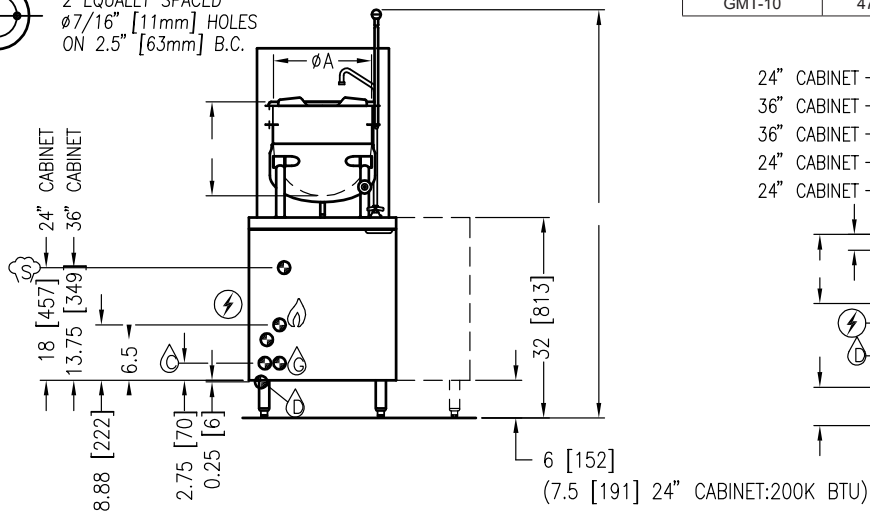

NOTE: SPLASH GUARD GRATES NOT SHOWN IN FRONT VIEW.

MODEL	SHIPPING WEIGHT	SHIPPING WEIGHT	
GMT-6	450 lbs. [204 kg.]	SIDES	3 [76mm]
GMT-10	470 lbs. [213 kg.]	BACK	6 [152mm]

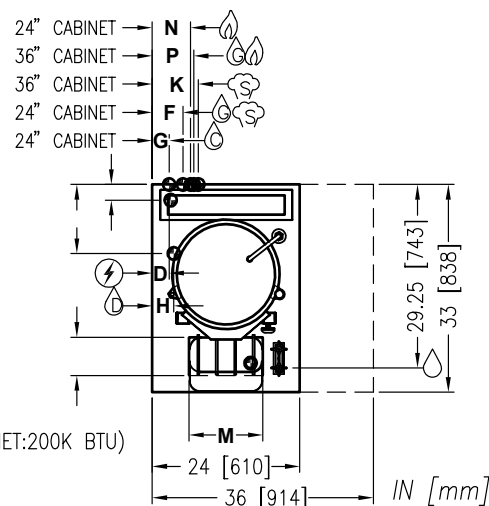
**SERVICE CONNECTIONS**

MODEL	A	B	C	D	E	F	G	H	J	K	L	M	N	P
GMT-6	12 [305]	14.5 [368]	66.13 [1680]	3 [76]	2.5 [64]	5 [127]	2.75 [70]	3.5 [89]	11 [279]	7.5 [191]	9 [229]	12 [305]	6.25	6.75
GMT-10	16 [406]	15 [381]	65.13 [1654]								6 [152]	12 [305]	[159]	[171]

- ELECTRICAL CONNECTION: 1/2" (13 mm) conduit connection to controls. 120 VAC-60Hz-1PH.  
2 Amps per compartment or as specified on data plate.
- DRAIN: 2" (51 mm) IPS piped to open floor drain. No solid connection.
- COLD WATER: 3/8" (10 mm) O.D. tubing at 25-50 PSI (170-345 kPa). (OPTIONAL)
- BROILER FEED WATER: 1/2 NPT at 25-50 PSI (170-345 kPa).
- HOT WATER: 3/8" (10 mm) O.D. tubing at 25-50 PSI (170-345 kPa)
- GAS CONNECTION: 3/4" (19 mm) IPS supply line required.
- STEAM TAKE-OFF CONNECTION: 3/4" (19 mm) IPS optional to operate adjacent equipment.

**GAS SUPPLY**

BTU/Hour	kW/Hour	WATER COLUMN PRESSURE	
		NATURAL	PROPANE
200,000	58.6	min. 4" (102 mm)	min. 11" (279 mm)
250,000	73.3		

**WATER QUALITY STATEMENT**

Water is the essential ingredient in steam equipment, water quality is the major factor affecting the performance of your appliance. Crown Steam Group offers a Comprehensive Water Treatment System which exceeds our minimum water requirements. Proof of installation and proper cartridges replacement is required for warranty coverage. Water supply to Crown Steam Group steamers must be within these guidelines.

Total dissolved solids.....Less than 60 PPM  
 Total alkalinity .....Less than 20 PPM  
 Silica.....Less than 13 PPM  
 Chlorine .....Less than 1.5 PPM  
 pH Factor .....6.8 - 7.3

Water which does not meet these standards should be treated with the installation of Middleby's Water Treatment System. Call 919-762-1000 if you have questions concerning your water meeting these parameters.

\*Failure or malfunction of this appliance due to poor water quality is not covered under warranty.

Reference [www.crownsteamgroup.com](http://www.crownsteamgroup.com) for complete warranty details and instructions.

**INTENDED FOR COMMERCIAL USE ONLY.  
 NOT FOR HOUSEHOLD USE.**



70 Oakdale Road, Toronto ON, Canada M3N 1V9  
 (919) 762-1000 [www.crownsteamgroup.com](http://www.crownsteamgroup.com)