



**John
BOOS**
Since 1887

ITEM #: _____ QTY: _____

MODEL #: _____

PROJECT NAME: _____

101321

3601 S. Banker St. Effingham, IL 62401 • P.O. BOX 609 • Ph: (888) 431-2667 • Fax: (800) 433-2667

"CUT4" WELD-IN / UNDERMOUNT SINKS 14GA

ONE COMPARTMENT

FEATURES:

- STANDARD 14 GAUGE TYPE 300 STAINLESS STEEL WITH #4 POLISH, SATIN FINISH
- 8", 10", 12", OR 14" BOWLS
- ALL CORNERS, BOTH VERTICAL AND HORIZONTAL COVERED AT 3/4" RADIUS
- BOTTOMS OF BOWLS FORMED FOR DRAINAGE TO 3-1/2" DIAMETER DIE STAMPED OPENING
- UNIFORM SINK BOWL THICKNESS

CONSTRUCTION:

- ALL TIG WELDED, EXPOSED WELDS ARE POLISHED TO MATCH ADJACENT SURFACE

MATERIAL:

- 14 GAUGE TYPE 300 STAINLESS STEEL WITH #4 POLISH, SATIN FINISH



WELD-IN / UNDERMOUNT SINKS 14GA

MODEL #	QTY
CUT1014084	
CUT1014104	
CUT1416124	
CUT1416144	
CUT1618124	
CUT1618144	
CUT1620124	
CUT1620144	
CUT1818124	
CUT1818144	
CUT1824124	
CUT1824144	
CUT2020084	
CUT2020124	
CUT2020144	
CUT2424124	
CUT2424144	

DETAILED SPECIFICATIONS

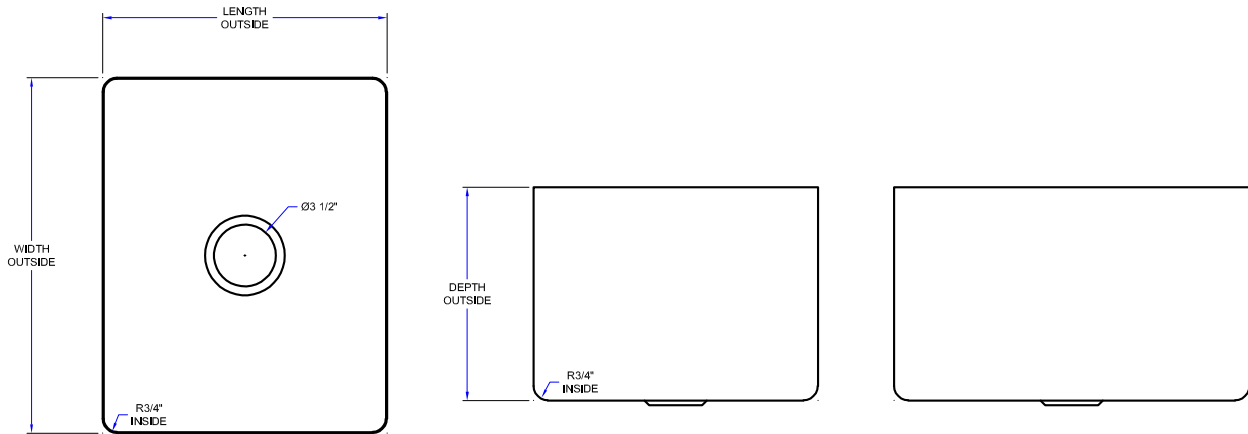

WELD-IN / UNDERMOUNT SINKS 14GA

MODEL #	INCLUDES	DIMENSIONS (W X L X D)	WEIGHT (LBS)
CUT1014084	CUTOUT, BOWL, FAUCET HOLES & WELDING/POLISHING (NOT AVAILABLE FOR FBLG & UFBLG)	10" X 14" X 8"	20
CUT1014104	CUTOUT, BOWL, FAUCET HOLES & WELDING/POLISHING (NOT AVAILABLE FOR FBLG & UFBLG)	10" X 14" X 10"	22
CUT1416124	CUTOUT, BOWL, FAUCET HOLES & WELDING/POLISHING (NOT AVAILABLE FOR FBLG & UFBLG)	14" X 16" X 12"	26
CUT1416144	CUTOUT, BOWL, FAUCET HOLES & WELDING/POLISHING (NOT AVAILABLE FOR FBLG & UFBLG)	14" X 16" X 14"	37
CUT1618124	CUTOUT, BOWL, FAUCET HOLES & WELDING/POLISHING (NOT AVAILABLE FOR FBLG & UFBLG)	16" X 18" X 12"	37
CUT1618144	CUTOUT, BOWL, FAUCET HOLES & WELDING/POLISHING (NOT AVAILABLE FOR FBLG & UFBLG)	16" X 18" X 14"	45
CUT1620124	CUTOUT, BOWL, FAUCET HOLES & WELDING/POLISHING (NOT AVAILABLE FOR FBLG & UFBLG)	16" X 20" X 12"	39
CUT1620144	CUTOUT, BOWL, FAUCET HOLES & WELDING/POLISHING (NOT AVAILABLE FOR FBLG & UFBLG)	16" X 20" X 14"	47
CUT1818124	CUTOUT, BOWL, FAUCET HOLES & WELDING/POLISHING (NOT AVAILABLE FOR FBLG & UFBLG)	18" X 18" X 12"	39
CUT1818144	CUTOUT, BOWL, FAUCET HOLES & WELDING/POLISHING (NOT AVAILABLE FOR FBLG & UFBLG)	18" X 18" X 14"	47
CUT1824124	CUTOUT, BOWL, FAUCET HOLES & WELDING/POLISHING (NOT AVAILABLE FOR FBLG & UFBLG)	18" X 24" X 12"	44
CUT1824144	CUTOUT, BOWL, FAUCET HOLES & WELDING/POLISHING (NOT AVAILABLE FOR FBLG & UFBLG)	18" X 24" X 14"	53
CUT2020084	CUTOUT, BOWL, FAUCET HOLES & WELDING/POLISHING (NOT AVAILABLE FOR FBLG & UFBLG)	20" X 20" X 8"	28
CUT2020124	CUTOUT, BOWL, FAUCET HOLES & WELDING/POLISHING (NOT AVAILABLE FOR FBLG & UFBLG)	20" X 20" X 12"	46
CUT2020144	CUTOUT, BOWL, FAUCET HOLES & WELDING/POLISHING (NOT AVAILABLE FOR FBLG & UFBLG)	20" X 20" X 14"	50
CUT2424124	CUTOUT, BOWL, FAUCET HOLES & WELDING/POLISHING (NOT AVAILABLE FOR FBLG & UFBLG)	24" X 24" X 12"	55
CUT2424144	CUTOUT, BOWL, FAUCET HOLES & WELDING/POLISHING (NOT AVAILABLE FOR FBLG & UFBLG)	24" X 24" X 14"	60

SOME UNITS SHIP UNASSEMBLED FOR REDUCED SHIPPING COST. ALL DIMENSIONS ARE TYPICAL. TOLERANCE +/- .500"

John Boos & Co. is constantly engaged in a program of improving products and therefore reserves the right to change specifications without prior notice.



3601 S. Banker St. • Effingham, IL 62401 • PO BOX 609 • quotes@johnboos.com

101321



www.johnboos.com

855