



# BEVERAGE-AIR

Project: _____	AIA# _____
Item: _____	
Location: _____	SIS# _____
Approved: _____	

## MARKETMAX DUAL TEMPERATURE REFRIGERATOR/FREEZER

MODEL:  
MMRF72HC-1-B-BW

MMRF72HC Glass Door Merchandiser  
Hydrocarbon Series

MMRF72HC Bottom Mount Dual Temperature Refrigerator/Freezer

**3 Year Parts/Labor Warranty**  
**Additional 4 Year Compressor Warranty**



### CABINET CONSTRUCTION

- Exterior finish is heavy duty steel with a black baked on durable coating
- Heavy duty interior construction includes white coated steel walls
- Brightly lit sign panel
- LED lighting, standards
- Modern one-piece grille
- Full electronic control with digital display
- Dual Temp refrigerator/freezer units provide two different operating temperature zones for different types of products
- Left: refrigerator single section has double pane lowE glass doors
- Right: freezer double section has triple pane lowE glass doors
- 120° stay open door feature, with automatic stay open feature
- Anti-microbial door handles
- Snap-in gaskets, easy to remove for cleaning or replacement
- Five (5) heavy duty epoxy coated wire shelves per door section
- Four (4) shelf clips included per shelf

### OPTIONS & ACCESSORIES

- White or stainless steel exterior
- Black or stainless steel interior
- Shelves black or white
- Stainless steel clips
- Flow track
- Gravity track
- Price tag molding
- 3" or 6" Casters
- Door locks (swing doors only)
- Electronic door lock  
(Must be ordered at time of unit order)
- Custom signage & decals
- Remote option\* (see note on back page)

### REFRIGERATION SYSTEM

- Uses environmentally friendly, energy efficient R290 refrigerant, and meets all regulatory requirements for CARB, SNAP, DOE & more
- Adaptive defrost
- Self-contained bottom mount refrigeration system
- Epoxy coated evaporator coil
- Freezer maintains product temperature to -10°F
- Refrigerator maintains product temperatures between 36°F to 38°F



  
Please verify qualifying units by visiting:  
[www.energystar.gov/cfs](http://www.energystar.gov/cfs)

3779 Champion Blvd., Winston-Salem, NC 27105  
1-888-845-9800 Fax: 1-336-245-6453  
Beverage-Air.com Sales@bevair.com



# BEVERAGE-AIR

## Dual Temp Merchandiser Glass Door Refrigerator /Freezer Model: MMRF72HC-1-B

MODEL	MMRF72HC-1-C
<b>EXTERNAL DIMENSIONAL DATA</b>	
Width Overall	75 1/8"
Depth Overall (with handle)	33 1/2"
Height Overall	78 1/8"
Number of Doors	3
Depth with Door Open 90°	55 1/8"
Door Openings (in)	21 7/8" x 52 5/8"
<b>INTERNAL DIMENSIONAL DATA</b>	
NET Capacity Refrigerator (cubic ft.)	19.62
NET Capacity Freezer (cubic ft.)	44.85
Internal Width Overall (in)	(R) 22" (F) 47"
Internal Depth Overall (in)	27"
Internal Height Usable (in)	53"
Number of Shelves	15
<b>ELECTRICAL DATA</b>	
Full Load Amperes Refrigerator	2.4
Full Load Amperes Freezer	11.0
<b>REFRIGERATION DATA</b>	
Horsepower* Refrigerator	1/4
Horsepower* Freezer	1
Capacity (BTU/Hr)* Refrigerator	1927
Capacity (BTU/Hr)* Freezer	2580
<b>SHIPPING DATA</b>	
Gross Weight - Crated	972 lbs
Height - Crated	85"
Width - Crated	77"
Depth - Crated	36"

\*NOTE: Remote units are field wired and come with 6" legs.  
Refrigerant must be specified at time of order.

### Model Views

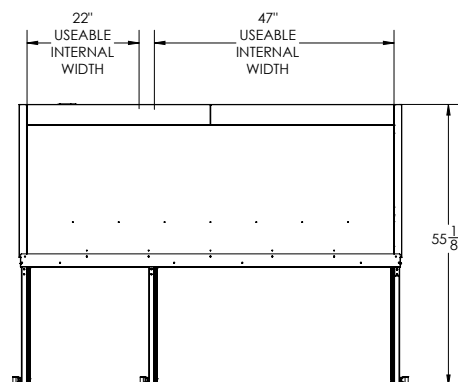

**PLAN VIEW**

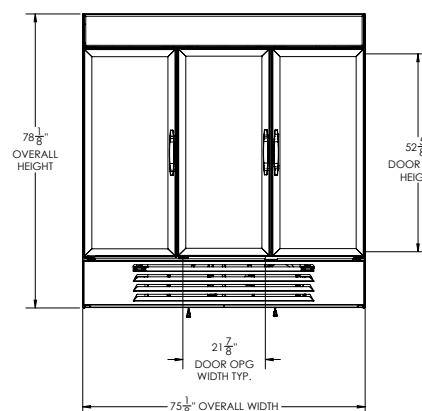

**ELEVATION VIEW**

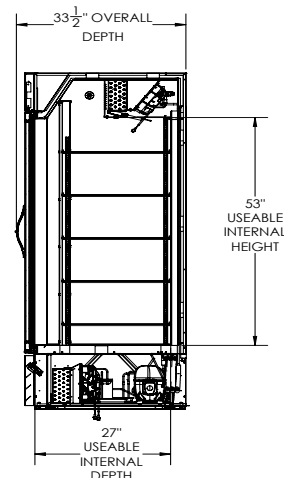

**SIDE VIEW**

### \*ELECTRICAL CONNECTION



115/60/1  
(2) NEMA 5-15P

Units pre-wired at factory  
and include 8' long cord  
and plug set.



an Ali Group Company



3779 Champion Blvd., Winston-Salem, NC 27105  
1-888-845-9800 Fax: 1-336-245-6453  
Beverage-Air.com Sales@bevair.com