



Glass Door Back Bar Coolers

Models: MBB-4824G, MBB-5928G, MBB-7224G, MBB-9028G

EQUIPMENT THAT DOMINATES
For Culinary Professionals



MBB-5928G

Glass Door Back Bar Coolers

Keep your drinks cold and accessible with Back Bar Coolers from CULITEK. Designed for undercounter use or can double as a work surface, these coolers offer great visibility and plenty of space to store your most popular brews! ETL Listed and ETL Sanitation, these units are backed with a 2 year warranty on parts and a 5 year warranty on the compressor. Also offered in solid door models.

Cooling System

- R290 hydrocarbon refrigerant is an environmentally-responsible choice for your business
- Condensing unit located behind front grill and slides out for easy cleaning
- Maintains a temperature range of 33°F to 41°F

Cabinet Construction

- Exterior is constructed of a durable black vinyl front and sides with an aluminum back
- Countertop is all stainless steel
- All stainless steel interior, floor, and walls
- Insulated cabinet with foamed-in-place, high density cell polyurethane insulation

Electrical Control

- Carel temperature controller initiates automatic defrost schedule for worry-free use
- 7-foot power cord with NEMA 5-15 plug

Door(s)

- Swing door-style with double pane thermal glass doors
- 12" long handles
- Positive seal doors
- Door locks on all models

Shelving

- Adjustable heavy-duty, PVC coated wire shelves
- Aluminum shelf support that are adjustable every 1/2"

Model Features

- Interior LED lighting provides greater visibility
- Stainless steel countertop is 1/2" thick

STANDARD FEATURES

- 304 stainless steel top, interior walls, and floor
- Exterior constructed of black steel with an aluminum back
- Balanced refrigeration system maintains temperature range of 33°F to 41°F
- Adjustable heavy-duty, PVC coated wire shelves
- Swing door-style with double pane thermal glass doors
- Side mounted compressor
- Foamed-in-place insulation helps provide strength, while helping to maintain internal temperature
- Eco-friendly R290 hydrocarbon refrigerant
- Door locks keeps drinks secure



Attention CA Residents PROP 65 WARNING

This product can expose you to chemicals, including lead, which are known to the State of California to cause cancer, birth defects, or other reproductive harm.

For more information, go to www.P65warnings.ca.gov

MADE IN CHINA



Glass Door Back Bar Coolers Specifications

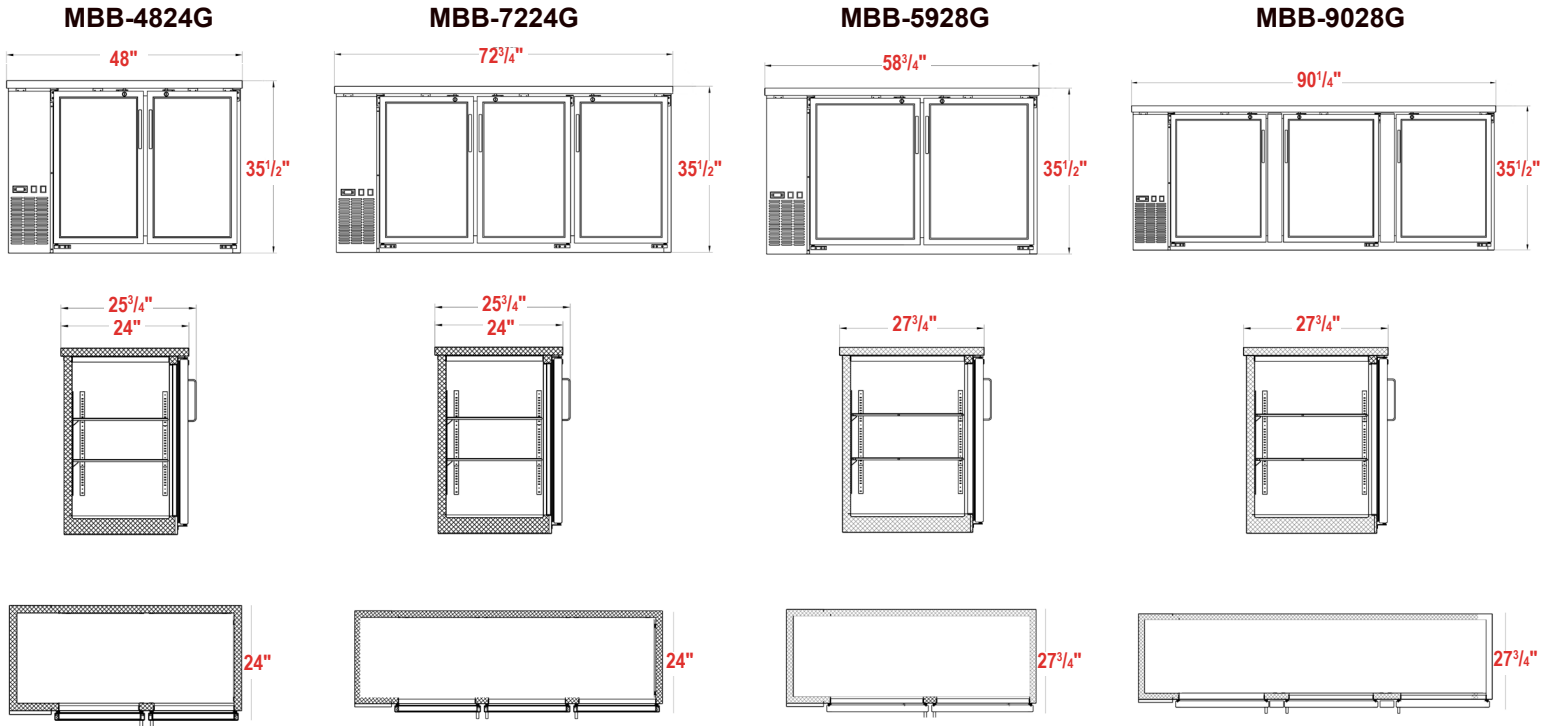

GLASS DOOR BACK BAR COOLERS

Model Number	MBB4824G	MBB7224G	MBB-5928G	MBB-9028G
Doors	2	3	2	3
Shelves	4	6	4	6
Net Volume (Cu. Ft.)	11.8	19.6	19	32
Overall Dimensions (in)	48"W x 24"D x 35.5"H	72.75"W x 24"D x 35.5"H	58.75"W x 27.75"D x 35.5"H	90.25"W x 27.75"D x 35.5"H
Interior Dimensions (in)	36"W x 18.5"D x 29"H	60"W x 18.5"D x 29"H	48"W x 22.5"D x 33"H	77.8"W x 22.5"D x 30.5"H
Horsepower	1/5	1/4	1/5	1/4
Refrigerant	R290	R290	R290	R290
Voltage/Hertz/Phase	115/60/1	115/60/1	115/60/1	115/60/1
Amps	2.88	3.96	2.8	4.7
Net Weight (lbs)	216	311	258	386
Gross Weight (lbs)	260	355	302	430
Shipping Dimensions (in)	51"W x 27.5"D x 41"H	75"W x 27.5"D x 41"H	61.5"W x 30.5"D x 41.75"H	91.75"Wx30.5" x 41.75"H
Half-Barrel Kegs (Cap)	2	3	2	4
12 oz. Cans (Cap)	48 (6-packs)	76 (6-packs)	88 (6-packs)	152 (6-packs)