



Chef Tables - Stainless Steel Top with 5" Riser

Stainless Steel Cabinet Base Tables with Sliding Doors

Certifications:



Features:

- 1 5/8" x 6" Straight S/S Leg
- Sliding Doors
- 5" Riser
- 96" Units have a Center Mullion with Two Sets of 48" Doors
- Legs Adjust 1" in Height
- Casters Available



Material:

- T-304 14 ga. Stainless Steel Top
- T-304 18 ga. Stainless Steel Body
- Stainless Steel Legs & Feet

Options:

- Adjustable Shelf



Length	24" Width	Product Weight (lbs)
48"	CSTR5-3648S	210
60"	CSTR5-3660S	260
72"	CSTR5-3672S	350
84"	CSTR5-3684S	375
96"	CSTR5-3696S	490
120"	CSTR5-36120S	436

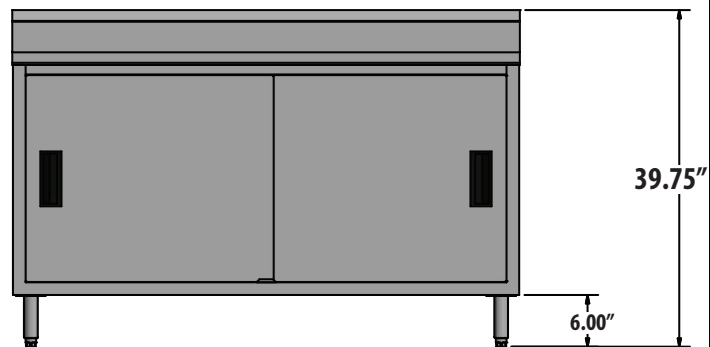
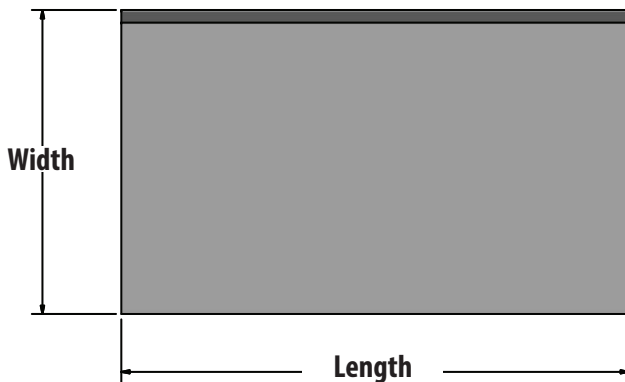

PRODUCT DATA SHEET

BK RESOURCES

