



RESOURCES

# UNDERBAR REFRIGERATION



Use your smart phone to scan the above QR code to visit our website: [www.bk-resources.com](http://www.bk-resources.com)

Model: **SSBB-3G-85**

## Back Bar Glass Doors



### SSBB-3G-85

- **Heavy Duty Construction**  
Durable 430 stainless steel top & interior with sealed interior floors
- **Electronic control system**  
Digital Temperature controller with automatic defrost system
- **Eco-Friendly Hydro-Carbon Refrigerant**  
R290 Refrigerant with a nominal global warming potential rating.
- **Easy Access Condenser**  
Allows for easy service, even in tight spaces. Note: Airflow direction is front to back
- **Holding Temp Range: 33°F to 41°F**
- **LED Interior Lighting**
- **Self Closing Doors with Locks and thermopane double glass**
- **3 Year Parts & Labor Warranty**
- **5 Year Compressor Warranty**



115/60/1  
Nema-5-15P



Commercial Use Only - Not warranted for residential use

Specifications subject to change without notice

Part Number	Doors	Shelves	Amps	HP	Voltage	Nema Plug	Cord Length	Unit Size (in) (l x w x h)
Glass Door								
SSBB-3G-85	3	6	6.0	1/5	115/60/1	5-15P	8 Foot	23.75" x 85.25" x 34.50"

ELEVATION

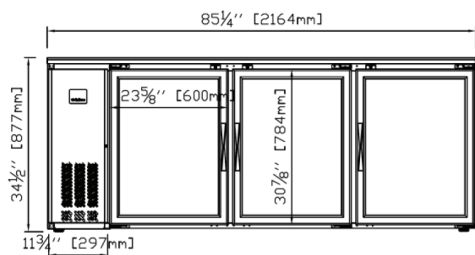

RIGHT VIEW

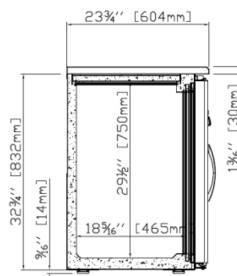

PLAN VIEW

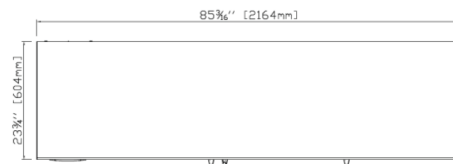

PRODUCT DATA SHEET

RESOURCES

