



Soiled Dish Tables

Dish Tables



Use your smart phone to scan the above QR code to visit our website:
www.bk-resources.com



Certifications:



Features:

- 1 5/8" Rolled Edge
- 20" x 20" x 8" Welded Bowl
- 30 3/8" O.A. Front to Back
- Front to Back End Bracing
- Accepts 8" O.C. Splash Mount Faucets
- 3.5" Drain Included: BKDR-4
- 10" Backsplash

Options:

- Pre-Rinse Units & Faucets
- Lever Drains
- Upgraded Bullet Feet
- Pre-Rinse Basket
- Rack Slide

Material:

S Series: S/S w/ Stainless Steel Legs & Bracing

- T-304 18 ga. Stainless Steel Top & Bowl
- Stainless Steel Legs & Bracing
- Adjustable S/S Over Plastic Bullet Feet

G Series: S/S w/ Galvanized Legs & Bracing

- T-304 18 ga. Stainless Steel Top & Bowl
- Galvanized Legs & Bracing
- Adjustable High Impact Corrosion Resistant Feet

S Series S/S w/ S/S Legs & Bracing			G Series S/S w/ Galv. Legs & Bracing		Sink Side
Length	T-304 S/S 30 3/8" Width	Product Weight (lbs)	T-304 S/S 30 3/8" Width	Product Weight (lbs)	
26"	BKSDT-26-R-SS	47.00	BKSDT-26-R	40.00	Right
	BKSDT-26-L-SS	47.00	BKSDT-26-L	40.00	Left
36"	BKSDT-36-R-SS	56.00	BKSDT-36-R	49.00	Right
	BKSDT-36-L-SS	56.00	BKSDT-36-L	49.00	Left
48"	BKSDT-48-R-SS	65.00	BKSDT-48-R	58.00	Right
	BKSDT-48-L-SS	65.00	BKSDT-48-L	58.00	Left
60"	BKSDT-60-R-SS	75.00	BKSDT-60-R	68.00	Right
	BKSDT-60-L-SS	75.00	BKSDT-60-L	68.00	Left
72"	BKSDT-72-R-SS	86.00	BKSDT-72-R	79.00	Right
	BKSDT-72-L-SS	82.00	BKSDT-72-L	75.00	Left

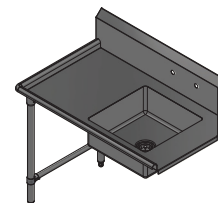
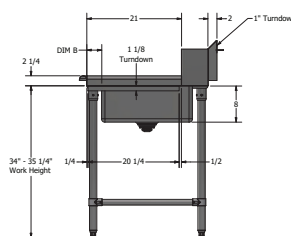
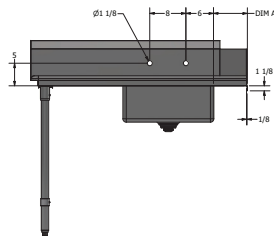
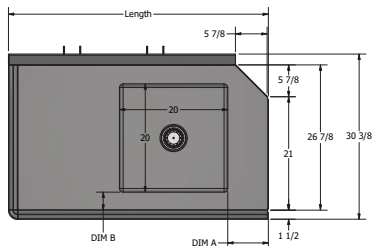

PRODUCT DATA SHEET

BK RESOURCES

