

General Information

Project Name: _____

Consultant: _____

Item #: _____

Model #: _____

Quantity: _____



Model #CSW9-2DX

Specifications

CSW9 Space Saver Wall Hand Sink is constructed of 20GA type 300 series stainless steel, with integral backsplash and apron. Sink bowl is deep drawn with marine edges and built-in pitch to 1 $\frac{7}{8}$ " waste outlet. Stainless steel front apron conceals bowl. Mount to wall with wall screws through top and lower brackets. Sink bowl is 9" x 9" x 5".

Includes electronic faucet model #EFD-1SG & model #T "P" Trap.

Sink is mounted to wall with screws through rear flanges and offset wall strip.

Product Guide

CS Hand Sinks are dual designed for Institutional and Commercial applications. For use in kitchens and public areas, with abuse resistant features, such as integral apron, multi-point mounting surfaces and high quality faucets.

These sinks are an economical version of Models WS and HS Sinks.

Options are designed to make the sink suitable for a variety of locations throughout the facility, such as prep areas, administrative, receiving and shipping and public areas.

Options

- ☐ **SS** - Side Splashes (Pair)
- ☐ **RSOD** - Rear Sink Overflow Drain
- ☐ **KNV** - Double Knee Valve
- ☐ **LD-2** - Lever Drain
- ☐ **LDO-2** - Lever Drain w/ Overflow
- ☐ **FPV** - Heavy Duty Foot Pedal Valve



Model #CSW9-2D-SSX
(See Above for Options)

WALL HAND SINK - CSW9

Sink Only Model	Sink w/ Faucet Model	Faucet Mounting	Overall Size (w x d)	Bowl Dim. (l x w x d)	Drain Size
<input type="checkbox"/> CSW9-1SX	<input type="checkbox"/> CSW9-1S	1 Hole Splash	12" x 14 $\frac{1}{2}$ "	9" x 9" x 5"	1 $\frac{7}{8}$ "
<input type="checkbox"/> CSW9-2SX	<input type="checkbox"/> CSW9-2S	4" OC Splash	12" x 14 $\frac{1}{2}$ "	9" x 9" x 5"	1 $\frac{7}{8}$ "
<input type="checkbox"/> CSW9-1DX	<input type="checkbox"/> CSW9-1D	1 Hole Deck	12" x 14 $\frac{1}{2}$ "	9" x 9" x 5"	1 $\frac{7}{8}$ "
<input type="checkbox"/> CSW9-2DX	<input type="checkbox"/> CSW9-2D	4" OC Deck	12" x 14 $\frac{1}{2}$ "	9" x 9" x 5"	1 $\frac{7}{8}$ "
<input type="checkbox"/> CSW9-1S-SSX	<input type="checkbox"/> CSW9-1S-SS	1 Hole Splash	12" x 14 $\frac{1}{2}$ "	9" x 9" x 5"	1 $\frac{7}{8}$ "
<input type="checkbox"/> CSW9-2D-SSX	<input type="checkbox"/> CSW9-2D-SS	4" OC Deck	12" x 14 $\frac{1}{2}$ "	9" x 9" x 5"	1 $\frac{7}{8}$ "
<input type="checkbox"/> CSW9-2S-SSX	<input type="checkbox"/> CSW9-2S-SS	4" OC Splash	12" x 14 $\frac{1}{2}$ "	9" x 9" x 5"	1 $\frac{7}{8}$ "



CSW9-30 1021

DRAWINGS

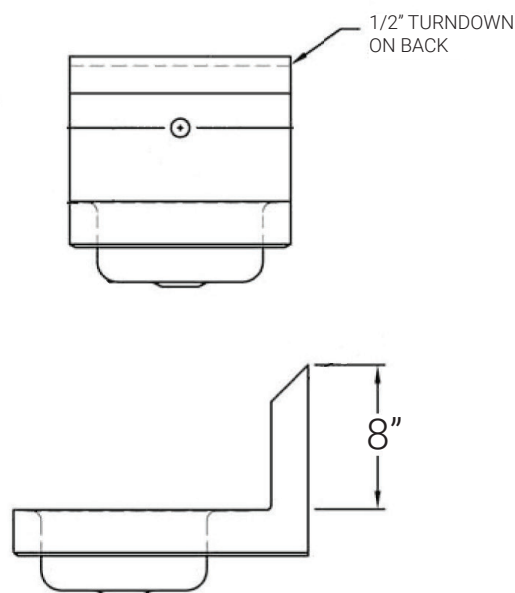
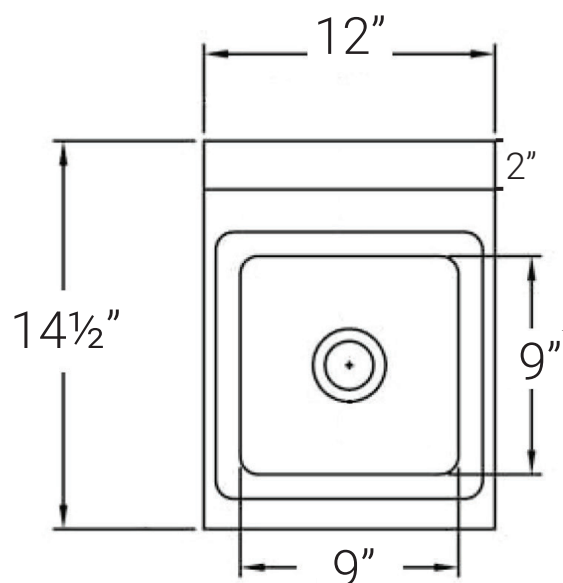

ACCESSORIES

(See Price Book Pg. 60-62)



Specifications subject to change without notice.

CSW9-30 1021